

1 Plan - Block B - Level 09  
1 : 200

The copyright of this drawing is vested with C+W O'Brien Ltd and must not be copied or reproduced without the consent of the company.

Figured dimensions only to be taken from this drawing. DO NOT SCALE. All contractors must visit the site and be responsible for checking all setting out dimensions and notifying the architect of any discrepancies prior to any manufacture or construction work.

NOTES:

- Legend
- Studio
  - 1 Bed - 2 Person
  - 2 Bed - 3 Person
  - 2 Bed - 4 Person
  - 3 Bed - 5 Person
  - Duplex - 2 Bed 4 Person
  - Residential Amenity
  - Creche Facility
  - Office
  - Commercial
  - Retail
  - Car parking
  - Bike parking
  - Plant room
  - Refuse storage
  - Bin Store
  - Substation / Switch room
  - Service
  - Sprinklers tank
  - Water storage room
  - Heating Centre
  - Circulation

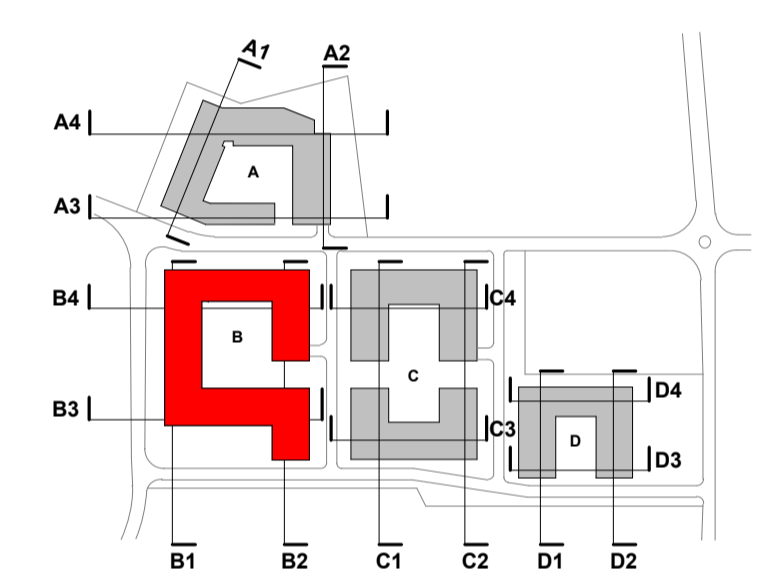

REV	DATE	SIGNED	NOTES

Project Stage  
**SHD Application**

Client  
Joseph Costello, Absolute Limousines Ltd and Boherhill Property Development Ltd.

Project  
Lands west of Old Belgard Road and north, south and west of Cookstown Road, Cookstown Industrial Estate, Tallaght, Dublin 24

Drawing Title  
**PLAN - BLOCK B - LEVEL 09**

Drawn: AB  
Checked: SOD  
Scale @ A1: As indicated  
Date: 12/10/19

Project No: 19127  
Drawing No: 1209

Drawing BIM Name:  
P19127-CWO-02-09-DR-A-1209

CDE Area	Suitability Code	Revision
	S2	